

# SGC Technologies Inc 140 MHz Bandpass Filter 3.0 MHz Bandwidth

312561

## Typical Performance

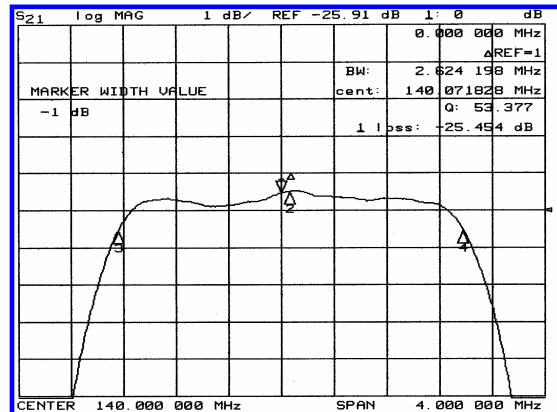
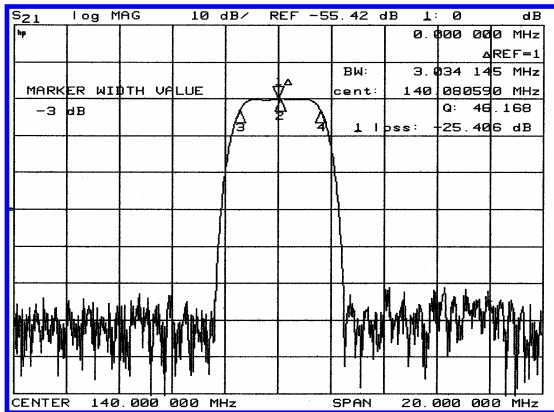

## Specification

| Parameter             | Unit | Min.   | Typ.   | Max.   |
|-----------------------|------|--------|--------|--------|
| Center Frequency      | Mhz  | 139.85 | 140.00 | 140.15 |
| Insertion Loss        | dB   | -      | 25.50  | 27.00  |
| 1dB Bandwidth         | MHz  | 2.40   | 2.62   | -      |
| 3dB Bandwidth         | Mhz  | 3.00   | 3.04   | -      |
| 40dB Bandwidth        | Mhz  | -      | 4.63   | 4.80   |
| Passband Ripple       | dB   | -      | 0.35   | 0.70   |
| Group Delay Variation | nsec | -      | 30     | 90     |
| Absolute Delay        | µsec | -      | 2.46   | -      |
| Ultimate Attenuation  | dB   | 50     | 55     | -      |
| Substrate Material    | -    | -      | Quartz | -      |

## Package Dimension

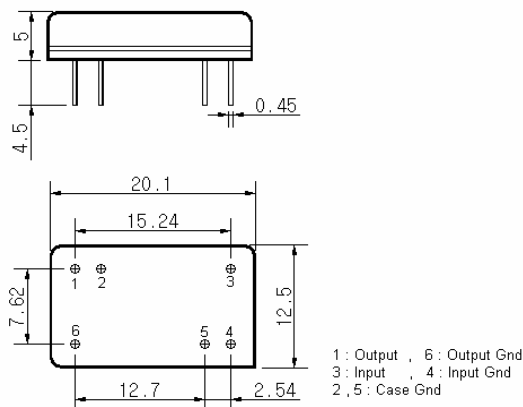

## Matching Configuration

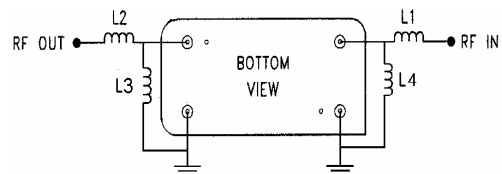

L1=L2=68nH, L3=L4=0.22µH  
 Source / Load Impedance = 50Ω  
 Ambient Temperature = 25°C

11/30/2002